

# **DERBYSHIRE COUNTY COUNCIL**

## **EMERGENCY TEMPORARY FOOTPATH CLOSURE**

### **PUBLIC FOOTPATH NO. 38 DETHICK, LEA & HOLLOWAY PARISH**

**WHEN:** 11<sup>th</sup> January 2021 to 24<sup>th</sup> January 2021.

**WHERE:** Close Public Footpath 38 from its junction with Public Footpath 43

**REASON:** To allow for the reconstruction of the collapsed towpath retaining wall.

**ALTERNATIVE ROUTE:** No alternative route recommended.

Access will be maintained, whenever reasonably possible, on the affected length of footpath. The footpath will re-open as soon as the work is finished. This may be earlier than advertised.

Derbyshire County Council apologises for any inconvenience caused while work takes place. Anyone needing further information should ring Call Derbyshire 01629 533190.

This notice is given under Section 14 of the Road Traffic Regulation Act 1984 (as amended) to prohibit its use by traffic.

Tim Gregory, Director – Economy, Transport and Communities, County Hall, MATLOCK DE4 3AG

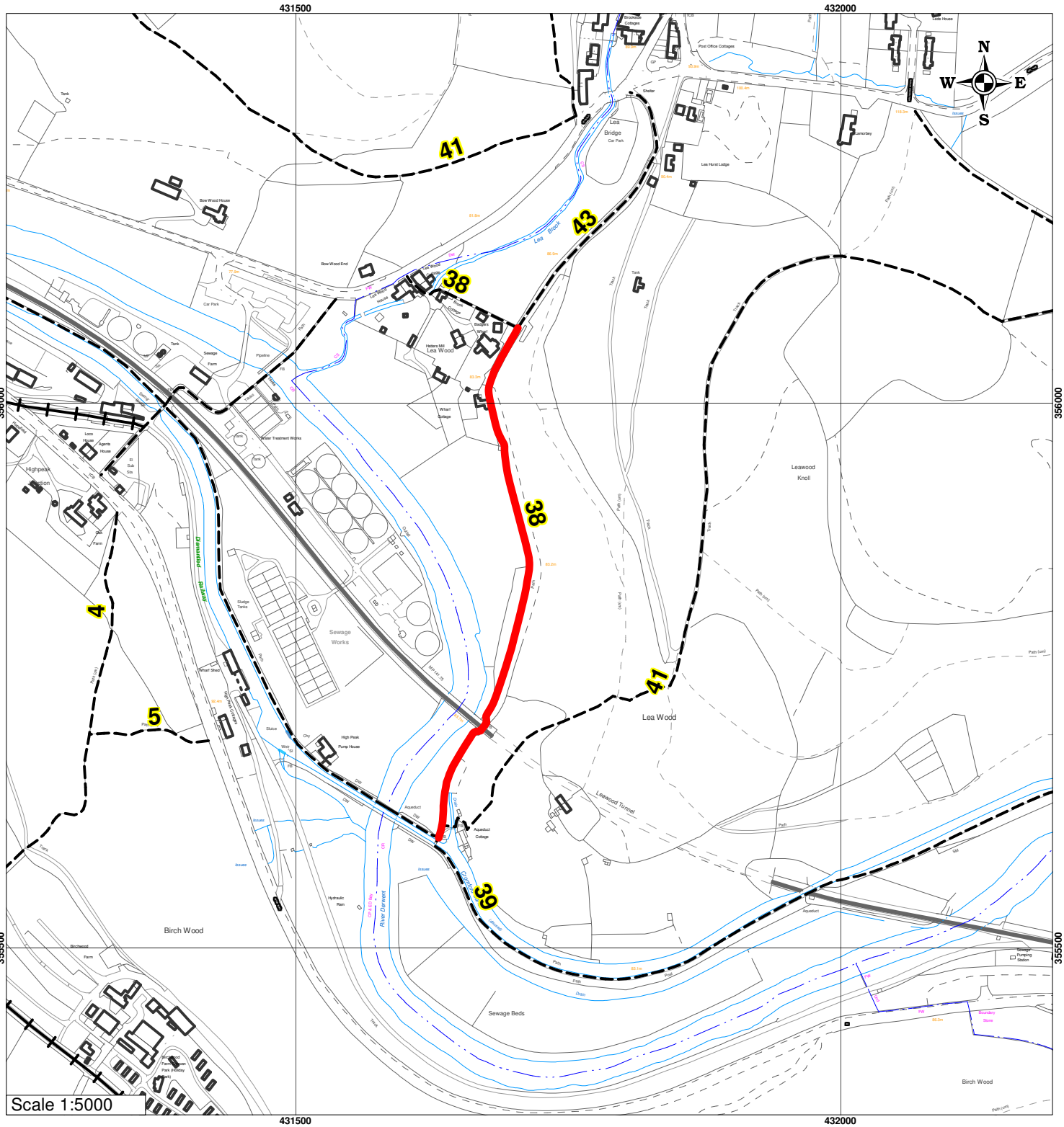

Scale 1:5000

Road Traffic Regulation Act 1984 s14  
**TEMPORARY CLOSURE**

DETHICK, LEA & HOLLOWAY FOOTPATH 38

**PATH  
CLOSED**



**UNAFFECTED  
FOOTPATH**



**PARISH  
BOUNDARY**



**UNAFFECTED  
BRIDLEWAY**



**Tim Gregory**

Director - Economy, Transport & Environment  
 Derbyshire County Council  
 County Hall  
 Matlock  
 DE4 3AG

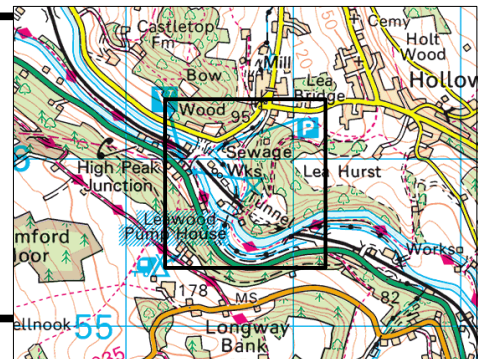

Produced by Public Rights of Way

Ref:

© Crown copyright and database rights [2018].  
 Ordnance Survey [100023251].

You are not permitted to copy, sub-licence, distribute or sell any of this data to third parties in any form.